

ORDINANCE NO. 2012-06

AN ORDINANCE AMENDING ORDINANCE NO. 2005-24 FOR SPECIAL USE PERMIT SUP12-01 (ENTERPRISE PIPELINE) FOR THE INSTALLATION OF A NATURAL GAS PIPELINE WITHIN A 24 INCH WIDE EASEMENT BEING APPROXIMATELY 6.7 MILES IN LENGTH LEGALLY DESCRIBED AS PORTIONS OF THE J. DICKINSON SURVEY, ABSTRACT 9; AND THE I. & G.N. R.R. SURVEY ABSTRACT 606 AND 596, GENERALLY LOCATED NORTH AND SOUTH OF FARM TO MARKET ROAD 518, WEST OF LANDING BLVD, TO THE NORTH OF LEAGUE CITY PARKWAY AND NORTH AND SOUTH OF MCFARLAND ROAD IN THE CITY OF LEAGUE CITY.

WHEREAS, at the May 1, 1999 General Election the qualified voters of the City of League City voted that staff proceed with the concept of zoning for the City; and

WHEREAS, on August 10, 1999, the City Council of the City of League City, Texas (the "Council") adopted Ordinance No. 99-52 amending the Code of Ordinances of the City of League City to add Chapter 125 regarding Zoning; and

WHEREAS, on August 30, 2005, the Council adopted Ordinance No. 2005-24 amending Chapter 125 of the Code of Ordinances of the City of League City and adopting zoning ordinances consistent with the Comprehensive Plan for the City of League City, Texas; and

WHEREAS, Section 125-50 provides that the City Council of the City of League City, Texas may grant a special use permit for special uses that are otherwise prohibited by this ordinance, and may impose appropriate conditions and safeguards to conserve and protect property and property values in the neighborhood; and

WHEREAS, the owner of a certain tract of land being considered for installation of a natural gas pipeline within a 24 inch wide easement being approximately 6.7 miles in length and containing approximately 1.52 acres on property zoned "OS" (Open Space) and "RSF-7-PUD" (Single-family residential with a minimum lot size of 7,000 square feet with a Planned Unit Development Overlay), legally described as portions of the J. Dickinson Survey, Abstract 9; and the I. & G.N. R.R. Survey Abstract 606 and 596, generally located north and south of Farm to Market Road 518, west of Landing Blvd, to the north of League City Parkway and north and south of McFarland Road in the City of League City; and

WHEREAS, the City Council of the City of League City, considered the affirmative recommendation of the Planning and Zoning Commission and duly conducted a public hearing as required by law; and

WHEREAS, the applicant presented adequate testimony that the proposed use to install a natural gas pipeline is consistent with the standards for issuance for a special use permit; and

WHEREAS, the City Council of the City of League City has discretionary authority under Section 125-50 and applicable law to grant or withhold approval of a special use permit.

NOW, THEREFORE, BE IT ORDAINED BY THE CITY COUNCIL OF THE CITY OF LEAGUE CITY, TEXAS, as follows:

Section 1. The facts and opinions in the preamble of this ordinance are true and correct.

Section 2. A special use permit is hereby granted and the 1.52-acre easement of land legally described as portions of the J. Dickinson Survey, Abstract 9; and the I. & G.N. R.R. Survey Abstract 606 and 596, generally located north and south of Farm to Market Road 518, west of Landing Blvd, to the north of League City Parkway and north and south of McFarland Road in the City of League City is hereby conferred a permitted special use to install a natural gas pipeline within the boundaries as depicted on the attached map in Exhibit "A" and the metes and bounds shown in Exhibit "B".

Section 3. All ordinances and agreements and parts of ordinances and agreements in conflict herewith are hereby repealed to the extent of the conflict only.

APPROVED first reading the 24th day of April, 2012.

APPROVED second reading the 8th day of May, 2012.

PASSED AND ADOPTED the 8th day of May, 2012.

TIMOTHY PAULISSEN
Mayor

ATTEST:

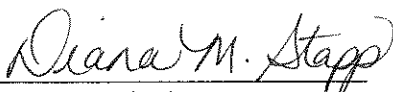
DIANA M. STAPP
City Secretary

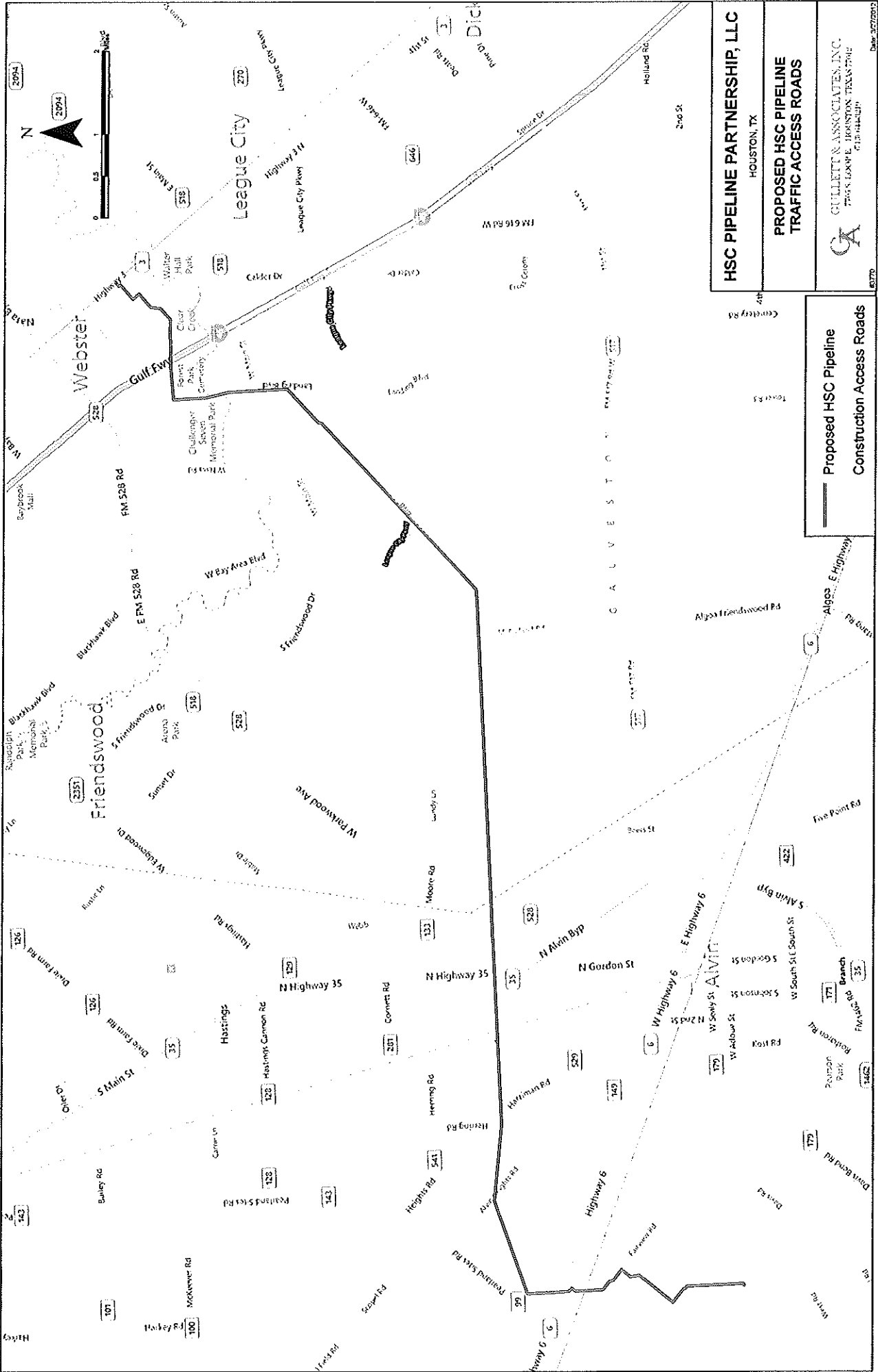

HSC PIPELINE PARTNERSHIP, LLC
HOUSTON, TX

PROPOSED HSC PIPELINE TRAFFIC ACCESS ROADS

GUILLETIN ASSOCIATES, INC.
7705 LAMAR, HOUSTON, TEXAS 77063
713-444-0111

DATE: 02/20/13

Proposed HSC Pipeline Construction Access Roads

February 10, 2011

STATE OF TEXAS

COUNTY OF GALVESTON & HARRIS

EXHIBIT "A"

**CENTERLINE DESCRIPTION FOR A
PROPOSED 24" PIPELINE
ACROSS CITY OF LEAGUE CITY**

Centerline description for a proposed twenty four (24") pipeline extending over, through, along and across the city of League City, Galveston and Harris County, Texas, said centerline being more fully described as follows:

Bearings and Coordinates are based on the Texas Coordinate System, South Central Zone (NAD 83 in feet).

BEGINNING at a point in the City Limits line of League City, "POINT OF BEGINNING" having coordinates N=13,735,131.99, E=3,174,367.54;

THENCE, North 87°03'21" East, at 88.0 feet pass the center of G.C.W.A. (Galveston Canal), at 914.5 feet pass the center of G.C.C.D.D. (Lundy Ditch), at 10,086.9 feet pass the center of Mcfarland Road, at 10,926.5 feet pass the center of G.C.C.D.D. (Box Ditch), and continuing for a total distance of 12,192.5 feet to a point;

THENCE, North 87°01'04" East, a distance of 822.2 feet to a point;

THENCE, North 46°53'33" East, at 1,437.6 feet pass the center of G.C.W.A. (American Canal), and continuing for a total distance of 1656.8 feet to a point;

THENCE, North 46°51'07" East, at 4,545.1 feet pass the center of Brittany Bay Boulevard, and continuing for a total distance of 5,107.1 feet to a point;

THENCE, North 46°44'21" East, at 773.1 feet pass the center of Magnolia Creek, at 1,166.7 feet pass the center of Magnolia Creek, at 2,926.8 feet pass the center of Bay Area Boulevard, and continuing for a total distance of 3,612.9 feet to a point;

THENCE, North 46°38'40" East, at 1,647.7 feet pass the center of Stormwater Ditch, and continuing for a distance of 2,402.2 feet to a point;

THENCE, North 46°53'13" East, a distance of 1,663.2 feet to a point;

THENCE, North 13°34'50" East, a distance of 206.2 feet to a point;

THENCE, North 46°40'37" East, at 500.9 feet pass the center of Floyd Road (not open), at 1,127.9 feet pass the center of Clear Creek Meadows Drive, at 1,768.7 feet pass the center of Green Cedar Drive, at 2,691.7 feet pass the center of Cedar Branch Drive, and continuing for a distance of 2,920.7 feet to a point;

THENCE, North 02°59'43" West, at 1,855.1 feet pass the center of F.M. 518/ West Main Street, and continuing for a distance of 3,688.2 feet to a point;

THENCE, North 14°26'30" West, at 160.1 feet pass the center of Drainage Ditch, at 1,161.0 feet pass the center of Clear Creek, and continuing for a distance of 1,526.1 feet to a point;

THENCE, North 02°52'09" West, a distance of 2,049.1 feet to a point;

THENCE, North 84°46'10" East, a distance of 222.2 feet to the POINT OF EXIT, said "POINT OF EXIT" having coordinates N=13,755,119.94, E=3,199,611.29.

Total Rods: 2,307.24

Plat attached.