



Department of Planning and Development
300 W Walker Street
League City, Texas 77573
(281) 554-1080

Case Number: SUP14-05

November 21, 2014

The City of League City's Planning and Zoning Commission and City Council will:

Hold a Public Hearing and consider a Special Use Application, **SUP14-05 (FM 518 and Landing Boulevard Gas Station)**, to allow for a gas and service station use on approximately 0.748 acres of property zoned "CM" (Commercial Mixed Use), legally described as being a 0.748-acre tract of land out of Dickinson Survey, Tract 8, generally located at the southeast intersection of West Main Street (FM 518) and Landing Boulevard, in League City, Texas.

Planning and Zoning Commission Meeting:

Date: December 15, 2014

Time: 6:00 p.m.

Location: Council Chambers, 200 West Walker St.

City Council Meeting:

Date: January 13, 2015

Time: 6:00 p.m.

Location: Council Chambers, 200 West Walker St.

You have received this notice because you are a property owner within 500 feet of the request. In accordance with Section 211.006(d) of the Texas Local Government Code: "If a proposed change to a regulation or boundary [zoning] is protested in accordance with this subsection, the proposed change must receive, in order to take effect, the affirmative vote of at least three-fourths of all members of the governing body. The protest must be written and signed by the owners of at least 20 percent of either the area of the lots or land covered by the proposed change; or the area of the lots or land immediately adjoining the area covered by the proposed change and extending 200 feet from that area."

A copy of the vicinity map is on the back of this notice. To view the staff report and other information for this application, please go to the City website at www.leaguecity.com/pandz, click on '2014 P&Z Commission Case Notification Log'. Items will be posted no less than 72 hours prior to the listed meeting above. For additional information, please contact Kris Carpenter at 281-554-1098 or via e-mail at kris.carpenter@leaguecity.com. Please reference case **#SUP14-05**.

Public Notification Map

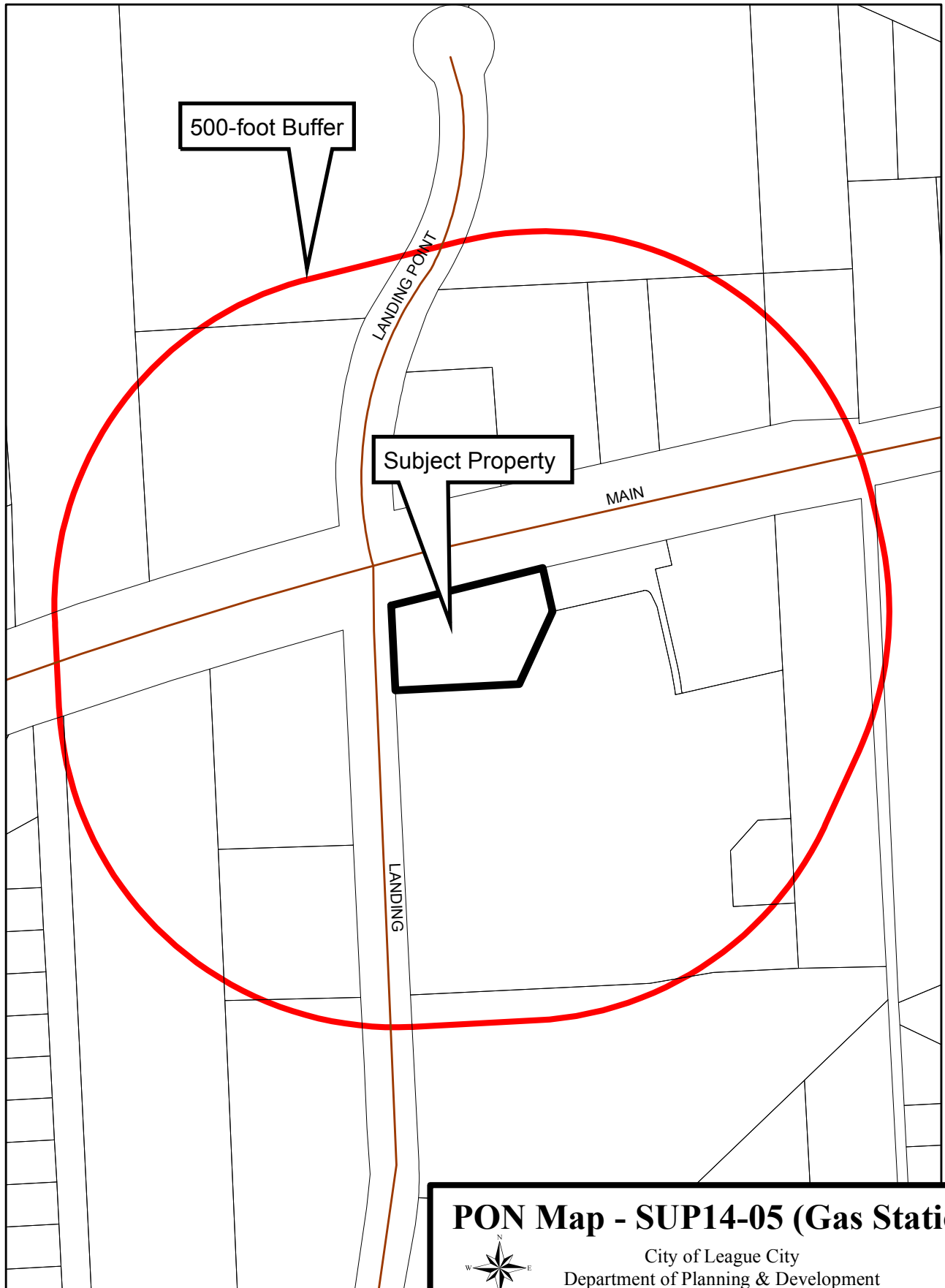

PON Map - SUP14-05 (Gas Station)



City of League City
Department of Planning & Development
For Planning Purposes Only

1 inch equals 208 feet